

OPENING DATE: FRIDAY, FEBRUARY 16 at 4:00 pm CT.
Walk-in entries accepted 8:30 am to 4:00 pm during work days.
Entries will not be accepted prior to the date and time listed above.

PREMIUM LISTS

CONFORMATION IS LIMITED TO 1400 ENTRIES EACH DAY

ENTRIES CLOSE WEDNESDAY NOON, MARCH 13, 2024, or when the limits have been reached, if reached prior to this date at Superintendent's Office. After which time entries cannot be accepted, canceled, altered or substituted except as provided for in Chapter 11, Section 6 of the Dog Show Rules.

All Breed Dog Shows, Obedience Trials & Rally Trials - Unbenched

Obedience & Rally entries open to All - American Dogs listed in the AKC Canine Partners Program



Scottsbluff Dog Shows

*Easter
Weekend
March 29-31,
2024*

Fast CAT
B-Match
Pee Wees
Best Veteran

Licensed by the American Kennel Club
www.scottsbluffkc.org



**2024 Shows are dedicated to the memory
of Suzanne Lilja-Kingma**

Conformation & Obedience - 2024172301 • Rally - 2024172302

FRIDAY, MARCH 29, 2024

Conformation & Obedience - 2024172303 • Rally - 2024172305

4-6 Month Beginner Puppy Competition - 2024172304

SATURDAY, MARCH 30, 2024

Conformation & Obedience - 2024172307 • Rally- 2024172306

SUNDAY, MARCH 31 2024

AKC NATIONAL OWNER-HANDLED SERIES ALL 3 DAYS

SCOTTS BLUFF COUNTY FAIRGROUNDS

Events Center Building • 130625 County Road E • Mitchell, Nebraska 69357
SHOW HOURS • 6:00 am to 10:00 pm

THESE SHOWS WILL BE HELD INDOORS

OFFICERS

Joan Beien • **President**
Linda Nagel • **Vice President**
Mary Sullivan • **Treasurer**
Grace Sulsberger • **Secretary**
PO Box 116, Torrington, WY 82440

BOARD OF DIRECTORS

Miranda Hill • Bill Rosenau • Jim Trujillo • Linda Veal • Linda K. Veal

SHOW COMMITTEE

Noreene Rodgers • **Show Chairman**
959 Oakcrest, Casper WY 82601 • (307) 259-7200
Daughn Trapp • **Obedience Chairman**
Linda Veal • **Rally Chairman**
718 Canal St, Scottsbluff, NE 69361 • (308) 635-2772
Officers of the Club & Members of the Board of Directors

COMMITTEES

Linda Nagel • **Catalog Advertising**
Linda K Veal • **Hotels**
Sue Ott • **Hospitality**
Linda Veal • **Public Education**
Bill Rosenau • **Publicity & Corporate Sponsorship**
Joan Beien & Linda K Veal • **Reserved Grooming & Vendor Booths**
6252 Highway 154, Torrington, WY 82240 • (307)715-7238 • jbeien@yahoo.com
Floyd Dunn • **RV & General Parking**
PO Box 50278, Casper, WY 82605 • (307)253-8018 • Timbermist@gmail.com
Joan Beien • **Trophies & Rosettes**

IN CASE OF EMERGENCY

Norene Rogers • (307) 259-7200

AED LOCATION

**Safety Booth at the
Southeast corner of the event building**

ENTRY FEES • (including AKC fees of \$3.50 per recordable entry)

Separate fee for each dog, each day

\$28.00 for First entry of each dog in Conformation & Obedience

\$23.00 Additional entry of same dog, unless otherwise specified

\$23.00 for Puppy & Bred-by-Exhibitor Classes

\$12.00 for Veteran Classes & Veteran Special Attraction

\$12.00 for Junior Showmanship Competition ONLY or **\$5.00** as an additional entry of same dog

\$23.00 for Brace as a Unit, both dogs must be entered in another class

\$12.00 for 4-6 Month Beginner Puppy Competition (includes \$2.00 AKC service fee) SAT

When a dog is entered in more than one class, the highest priced class is considered the first entry.

RALLY ENTRY FEES

Separate fee for each dog, each day

\$28.00 for First entry of each dog

\$23.00 for Additional entry of same dog

NOTICE: PLEASE PUT BREED & NAME OF SHOW ON CHECK

OBEDIENCE/RALLY PRACTICE

\$5.00 for Five Minutes Friday

Check with Rally Chairman, Lin Veal for times



**AMERICAN
KENNEL CLUB®**

CERTIFICATION

Permission has been granted by the American Kennel Club for the holding of this event under the American Kennel Club rules and regulations.

GINA M. DINARDO, Executive Secretary

Member: Dog Show Superintendents Association



American
Kennel Club
Annually Licensed
Superintendents

John Goosen • Candy E James • Christopher L James
H T (Terry) James • Mary Beth James • Tim E James • Zach James
John McDonald • Sandi McDonald • Antony M Onofrio
Jack David Onofrio • Patricia Onofrio • Sue Onofrio • Tiffany R Fields Peterson
Glen Power • Luann Ramsey • Reggie Turner • Sharon Turner

PO Box 25764 • Oklahoma City, Oklahoma 73125-0764

Phone: (405) 427-8181 • www.onofrio.com

COVID WAIVER

By coming to this show and being on the Scotts Bluff County Fairgrounds property you are accepting full responsibility for your own health as it relates to COVID. No one associated with this show shall be held liable if you contract COVID. We will do our absolute best to make the show site a clean and safe environment, but ultimately, it is your responsibility to follow guidelines &/or mandates, or to exit an unhealthy situation. **BY COMING TO THIS SHOW YOU ARE ACCEPTING THAT RISK.** Being knowledgeable of the State of Nebraska and Scotts Bluff County guidelines and/or mandates is your responsibility. We will take no responsibility for making sure you are aware of any changes to those restrictions except through signs posted throughout the show site or to answer your questions by one of the club officers.

Restrictions regarding COVID may be updated due to conditions on the day of the Show(s).

CRATES

Crates MAY be brought ringside no more than 15 minutes prior to show time. They must be removed immediately after judging for that breed. If you are the first breed in the ring, you may arrive 30 minutes prior as long as the ring is vacant

Junior Scholarships!

\$700.00 Scholarship

to the BEST JUNIOR HANDLER

&

\$350.00 Scholarship

to the RESERVE BEST JUNIOR HANDLER

Offered by Scottsbluff Kennel Club

Saturday, March 30, 2024



Funds will be mailed to the Junior's chosen college or trade school at enrollment

JUNIOR SHOWMANSHIP COMPETITION

NOVICE JUNIOR CLASS - For Boys and Girls at least 9 and under 12 years of age on the day of the show who at the time entries close, have not won three (3) first place awards★, with competition present, in a Novice Class at a licensed or member show.

NOVICE INTERMEDIATE CLASS - For Boys and Girls at least 12 and under 15 years of age on the day of the show who at the time entries close, have not won three (3) first place awards★, with competition present, in a Novice Class at a licensed or member show.

NOVICE SENIOR CLASS - For Boys and Girls at least 15 and under 18 years of age on the day of the show who at the time entries close, have not won three (3) first place awards★, with competition present, in a Novice Class at a licensed or member show.

OPEN JUNIOR CLASS - For Boys and Girls at least 9 and under 12 years of age on the day of the show who at the time entries close, have won three (3) first place awards★ in a Novice Class at a licensed or member show, with competition present in the Novice Class.

OPEN INTERMEDIATE CLASS - For Boys and Girls at least 12 and under 15 years of age on the day of the show who at the time entries close, have won three (3) first place awards★ in a Novice Class at a licensed or member show, with competition present in the Novice Class.

OPEN SENIOR CLASS - For Boys and Girls at least 15 and under 18 years of age on the day of the show who at the time entries close, have won three (3) first place awards★ in a Novice Class at a licensed or member show, with competition present in the Novice Class.

MASTER CLASS - For Boys and Girls at least 9 and under 18 years of age on the day of the show and who have won ten (10) Best Junior Handler awards with competition. The calendar for this class will be consistent with the eligibility dates for the AKC National Championship. All juniors meeting the criteria for this class are required to enter the Master Class and must change their entry the day of the show if entries have already closed. Once the eligibility time frame for that year has passed, all participants return to the Open Class to compete for the following year.

★ A first place in Novice without competition leading to a Best Junior award with competition counts as one win towards moving to Open.

NOTICE: Junior Handlers must include their AKC JUNIOR HANDLER NUMBER on each entry. To obtain junior identification number contact juniors@akc.org

BE SURE ALL INFORMATION for Junior Showmanship Classes is entered on front and back of entry form.



Juniors Suit Exchange

Available all 3
days of the show
on the stage in
the Free Grooming
Building

All are welcome!

• RIBBON/ROSETTE PRIZES WILL BE AS FOLLOWS •

REGULAR CLASSES		RALLY CLASSES	
First Prize	Blue	Highest Scoring Triple Qualifying Score	Red & Blue
Second Prize	Red	Highest Combined Score in Advanced B & Excellent B	Blue & Green
Third Prize	Yellow	Rally Classes	Blue & Green
Fourth Prize	White	Qualifying Score	Dark Green
Winners	Purple		
Reserve Winners	Purple and White	VARIETY GROUPS	
Best of Winners	Blue and White	First Prize	Blue
Best of Breed	Purple and Gold	Second Prize	Red
Best of Variety of Breed	Purple and Gold	Third Prize	Yellow
Best of Opposite Sex to Best of Breed and to		Fourth Prize	White
Best of Variety of Breed	Red and White	Best in Show	Red, White and Blue
Select	Light Blue and White	Reserve Best in Show	Red, Silver and Blue
		NON-REGULAR CLASSES	
OBEDIENCE CLASSES		First Prize	Rose
Highest Scoring Dog in the Regular		Second Prize	Brown
Obedience Classes	Blue and Gold	Third Prize	Light Green
Highest Combined Score in Open B & Utility		Fourth Prize	Gray
Obedience Classes	Blue & Green		
Qualifying Score	Dark Green		

• CLASSIFICATION •

Regular Classes

Puppy, Dogs	6 months & under 9 months	Puppy, Bitches	6 months & under 9 months
	9 months & under 12 months		9 months & under 12 months
Twelve to Eighteen Month, Dogs		Twelve to Eighteen Month, Bitches	
Novice, Dogs		Novice, Bitches	
Amateur-Owner-Handler, Dogs		Amateur-Owner-Handler, Bitches	
Bred-by-Exhibitor Puppy, Dogs		Bred-by-Exhibitor Puppy, Bitches	
Bred-by-Exhibitor Adult, Dogs		Bred-by-Exhibitor Adult, Bitches	
American-bred, Dogs		American-bred, Bitches	
Open, Dogs		Open, Bitches	
WINNERS, DOG		WINNERS, BITCH	

Best of Breed (Variety) Competition

SATURDAY & SUNDAY

NON-REGULAR (ADDITIONAL) CLASSES Involving Single Dog Entries

VETERAN DOG CLASS - A Class for Dogs seven (7) years or older.

VETERAN BITCH CLASS - A Class for Bitches seven (7) years or older.

SEE FRIDAY VETERAN SPECIAL ATTRACTION INFORMATION ON NEXT PAGE

FRIDAY, SATURDAY & SUNDAY

NON-REGULAR (ADDITIONAL) CLASSES Involving Multiple Dog Entries

As the judge's decision in the Non-Regular Classes involving Multiple Dog Entries is based on the merits of more than one dog or bitch, none of the dogs or bitches making up the entry judged first in these classes will be eligible to compete for Best of Breed By Virtue Having won these classes.

BRACE CLASS- Two dogs of the same Breed or Variety of Breed with one or more common owner and both dogs must be entered in another class.

The above classification is provided for all breeds (and varieties). Additional divisions, i.e.(age, color or weight) are in the breed list and must be indicated on the entry.

OPEN CLASS DIVISIONS

DACHSHUNDS (ALL THREE VARIETIES): Miniature - 11 lbs & under & 12 mos old or over; Standard- Over 11 lbs & 11 lbs & under if less than 12 mos old

BOXERS: Brindle; Fawn

BULLMASTIFFS: Brindle; AOAC

DOBERMAN PINSCHERS: Black; AOAC

GIANT SCHNAUZERS: Black; Pepper & Salt

GREAT DANES: Black; Blue; Brindle; Fawn; Harlequin; Mantle; Merle

PUGS: Black; Fawn

BOSTON TERRIERS: Under 15 lbs; 15 lbs & over

CHINESE SHAR-PEI: Brushcoat; Horsecoat

DALMATIANS: Black Spotted; Liver Spotted

AUSTRALIAN SHEPHERDS: Blue Merle; Black; Red Merle; Red

COLLIES (ROUGH): Blue Merle; Sable & White; Tri-Color; White

SHETLAND SHEEPDOGS: Sable & White; AOAC

AKC NATIONAL OWNER-HANDLED SERIES FRIDAY, SATURDAY, & SUNDAY

The AKC National Owner-Handled Series is a non-titling competition for dogs that are exhibited by their owners that are not professional handlers.



“DON’T FORGET TO CHECK THE OWNER-HANDLED BOX ON THE ENTRY FORM IF ENTERING THIS COMPETITION.”



All dogs that are owner-handled and are not exhibited in the National Owner-Handled Series by professional handlers* meet the requirements for this competition. Exhibitors must declare their dog is Owner-Handled eligible at the time of entry using the check box on the entry form. Eligible dogs will be identified by an asterisk in the steward’s book & the catalog. **Dogs must be handled throughout the breed level competition for the regular show by an eligible owner. Professional handlers, household members and current assistants to professional handlers may not exhibit the dog in any AKC National Owner-Handled Series competition during the entire show. A current assistant is defined by anyone employed by a professional handler on a full-time basis, or assisting a professional handler at the show or any show during the cluster/weekend, however current assistants that are eligible to compete in Junior Showmanship (meet age and amateur status requirements) may participate in NOHS.**

Owner-Handled Best of Breed will be selected from the dogs that are competing in the Best of Breed competition including Winners Dog, Winners Bitch and winners of the non-regular classes.

The breed will not be represented in the Owner-Handled Group if there is no eligible dog competing in the Best of Breed, or in Best of Winners competition.

**Professional handlers are defined as any person who belongs or has belonged to a professional handlers’ organization, distributed rate cards, or otherwise advertised or represented themselves as handling dogs for pay within the last five years.*

VETERAN FRIDAY • SPECIAL ATTRACTION BREED • GROUP • BEST IN SHOW

Competition is offered for dogs & bitches 7 years & older (*divided by sex*) from Best of Breed Veteran through Best Veteran in Show. **Neutered dogs & spayed bitches are eligible to compete.** Veteran Best of Breed will be judged following the regular classes in each breed, Veteran Variety Groups will be held.

SATURDAY

Beginner Puppies (4-6 months of age)

AKC Sanctioned Beginner Puppy Competition!

Section 1- Classifications

The Four-to-Six Month Puppy competition shall be for dogs that are four months of age and over but under six months on the day of the event.

Section 2 – Entry and Eligibility

Entry and eligibility requirements include:

- The Four-to-Six Month Puppy event may be offered at licensed or member dog shows at the option of the show giving club.
- Four-to-Six Month Puppy Competition must be listed in the premium list, entry form and judging schedule, if offered.
- AKC registration number or an AKC litter number will be required for all entries.
- A foreign born dog may enter this class if they are registered in the country of origin.
- All entrants are to be vaccinated (including rabies) in accordance with their veterinarian's protocol.
- Professional handlers, members of their household and current assistants to professional handlers may not personally exhibit dogs in the Four-to-Six Month (Beginner Puppy) Competition. Dogs that are owned or co-owned by the forenamed may compete in this competition but must be handled by a non-professional handler. Professional handlers are defined as any person who belongs or has belonged to a professional handlers' organization, distributed rate cards, or otherwise advertised or represented themselves as handling dogs for pay within the last five years.
- Minors (under 18) with amateur status who reside with professional handlers and current assistants to professional handlers that are eligible to compete in Junior Showmanship (meet age and amateur status requirements) may personally exhibit dogs in the Four-to-Six Month Beginner Puppy Competition.

Entries will close Wednesday Noon, March 13, 2024 at Superintendent's office.

JUDGE

Mrs Rosalind Kramer



**The
Fun Match
is back!**

+ PRIZES + PRIZES + PRIZES + PRIZES +

THURSDAY, MARCH 28, 2024

6 PM

SHOW BUILDING, RINGS 1-6

OPEN TO ALL CLASS DOGS (& BITCHES)

JUNIOR & SENIOR SHOWMANSHIP

No Champions please



Want to see your dog run full speed?
Try FastCAT, a 100 Yard dash chasing a “bunny”!

**The Scottsbluff Kennel Club is excited
to announce FastCAT is BACK,
held in conjunction with the dog show,
March 29-31st!**

**2 Trials Per Day run CONCURRENTLY
for a total of 6 Trials!**

**For full premium list and to enter go to:
www.HarmonyDogSports.com/events**



Lets do Pee Wees!



Saturday, March 30, 2024

FREE

DAY OF SHOW ENTRY ONLY

AT THE CATALOG TABLE

With Judge Sherry MacLennan

A pre-Junior Showmanship class geared toward children 5 to 9 years of age at all shows offering Pee Wee.

Each Pee Wee unit consists of the child, his/her parent/guardian/responsible adult and the dog. Only one Pee Wee unit is in the ring at a time. This is not a competitive class, but rather a fun, learning experience for the child and adult.

Prizes will be a rosette and backpack with pens, pencils, pads, bracelets, stickers and dog toys. A prize is offered to each Pee Wee.

- A dog must be at least 4 months of age to enter into the Pee Wee class.
- Bitches in season will not be allowed to participate.
- All dogs entered must have a proper lead and collar.
- A responsible adult must be present with the child both inside and outside of the ring. The adult is to maintain control of the dog outside of the ring.
- All FSS and Miscellaneous Class breeds and All American Dogs are allowed to enter, including dogs with a PAL listing.
- Dogs need not be registered.
- In addition to an entry, a release must be signed by the child's parent or legal guardian. Release forms will be available at the show.

The safety of both the dogs and Juniors inside and outside of the ring is a primary concern. Outside of the ring, the dog is to be controlled by the adult accompanying the child. An additional lead, provided by the Club, will be at the Judge's table. At the Judge's discretion based upon the size of the child and the dog, for safety purposes the adult may be asked to attach a second lead to the dog so both child and adult will walk the dog together.

JUDGES

Ellen Beasley - 97 Hoot Owl Ln, Siler City NC 27344

Mrs Honey Anne Glendinning - 170 Blackfoot Court West, Lethbridge AB Canada T1K7W1

Mr Ronald V Horn* - 5880 S Gilpin Ct, Greenwood Village CO 80121

Mrs Margaret S Jones - 4940 Coventry Ln, Ladysmith BC CANADA V0R2W3

Mrs Rosalind Kramer - 1410 Heathcliff Rd, High Point NC 27262

Mr Robert L Robinson* - 1826 Palmcroft Way NE, Phoenix AZ 85007

Ms Joyce A Vanek - 476 S Meadow Vista Dr, Evergreen CO 80439

Mr Darryl Vice - 22075 Skyview Dr, Palm Springs CA 92262

** One or more breed assigned approved as provisional/permit by AKC*

VARIETY GROUP JUDGES

SCOTTSBLUFF KENNEL CLUB (1)-FRIDAY

- Ms Joyce A Vanek • Sporting Group
- Mrs Margaret S Jones • Hound Group
- Mr Darryl Vice • Working Group
- Mrs Rosalind Kramer • Terrier Group
- Mrs Rosalind Kramer • Toy Group
- Mr Darryl Vice • Non-Sporting Group
- Mrs Honey Anne Glendinning • Herding Group
- Mr Robert L Robinson • Best In Show

OWNER-HANDLED VARIETY GROUPS (1)-FRIDAY

- Mrs Honey Anne Glendinning • Sporting Group
- Mrs Rosalind Kramer • Hound Group
- Mr Robert L Robinson • Working Group
- Ms Joyce A Vanek • Terrier Group
- Mrs Margaret S Jones • Toy Group
- Mrs Honey Anne Glendinning • Non-Sporting Group
- Ms Joyce A Vanek • Herding Group
- Mr Ronald V Horn • Best In Show

SCOTTSBLUFF KENNEL CLUB (2)-SATURDAY

- Mrs Honey Anne Glendinning • Sporting Group
- Mr Robert L Robinson • Hound Group
- Ms Joyce A Vanek • Working Group
- Mr Darryl Vice • Terrier Group
- Mr Darryl Vice • Toy Group
- Mr Ronald V Horn • Non-Sporting Group
- Mr Robert L Robinson • Herding Group
- Mrs Margaret S Jones • Best In Show

OWNER-HANDLED VARIETY GROUPS (2)-SATURDAY

- Mrs Rosalind Kramer • Sporting Group
- Mr Ronald V Horn • Hound Group
- Mr Ronald V Horn • Working Group
- Mrs Margaret S Jones • Terrier Group
- Mrs Rosalind Kramer • Toy Group
- Mr Darryl Vice • Non-Sporting Group
- Mrs Margaret S Jones • Herding Group
- Mrs Honey Anne Glendinning • Best In Show

SCOTTSLUFF KENNEL CLUB (3)-SUNDAY

- Mr Robert L Robinson • Sporting Group
- Mrs Rosalind Kramer • Hound Group
- Mrs Honey Anne Glendinning • Working Group
- Mrs Margaret S Jones • Terrier Group
- Mrs Margaret S Jones • Toy Group
- Mrs Margaret S Jones • Non-Sporting Group
- Ms Joyce A Vanek • Herding Group
- Mr Darryl Vice • Best In Show

OWNER-HANDLED VARIETY GROUPS (3)-SUNDAY

- Mrs Margaret S Jones • Sporting Group
- Mrs Honey Anne Glendinning • Hound Group
- Mrs Rosalind Kramer • Working Group
- Mrs Rosalind Kramer • Terrier Group
- Mr Ronald V Horn • Toy Group
- Ms Joyce A Vanek • Non-Sporting Group
- Mrs Honey Anne Glendinning • Herding Group
- Ms Joyce A Vanek • Best In Show

JUDGING ASSIGNMENTS

SPORTING BREEDS	SCBL1-(FRI)	SCBL2-(SAT)	SCBL3-(SUN)
Barbet	M S Jones	H A Glendinning	R L Robinson
Bracchi Italiani	M S Jones	H A Glendinning	R L Robinson
Brittany	M S Jones	R Kramer*	R L Robinson
Lagotti Romagnoli	M S Jones	H A Glendinning	R L Robinson
Nederlandse Kooikerhondjes	M S Jones	H A Glendinning	R L Robinson
Pointers	J A Vanek	R Kramer*	R L Robinson
Pointers (German Shorthaired)	J A Vanek	R Kramer*	R L Robinson
Pointers (German Wirehaired)	J A Vanek	R Kramer*	R L Robinson
Retrievers (Chesapeake Bay)	J A Vanek	H A Glendinning	R L Robinson
Retrievers (Curly-Coated)	J A Vanek	R Kramer*	R L Robinson
Retrievers (Flat-Coated)	J A Vanek	H A Glendinning	R L Robinson
Retrievers (Golden)	J A Vanek	H A Glendinning	R L Robinson
Retrievers (Labrador)	J A Vanek	R Kramer*	R L Robinson
Retrievers (Nova Scotia Duck Tolling)	J A Vanek	H A Glendinning	R L Robinson
Setters (English)	J A Vanek	H A Glendinning	R L Robinson
Setters (Gordon)	J A Vanek	H A Glendinning	R L Robinson
Setters (Irish)	J A Vanek	H A Glendinning	R L Robinson
Setters (Irish Red And White)	J A Vanek	H A Glendinning	R L Robinson
Spaniels (American Water)	J A Vanek	H A Glendinning	R L Robinson
Spaniels (Boykin)	J A Vanek	H A Glendinning	R L Robinson
Spaniels (Clumber)	J A Vanek	R Kramer*	R L Robinson
Spaniels (Cocker) Black	J A Vanek	R Kramer*	R L Robinson
Spaniels (Cocker) Ascob	J A Vanek	R Kramer*	R L Robinson
Spaniels (Cocker) Parti-Color	J A Vanek	R Kramer*	R L Robinson
Spaniels (English Cocker)	J A Vanek	R Kramer*	R L Robinson
Spaniels (English Springer)	J A Vanek	R Kramer*	R L Robinson
Spaniels (Field)	J A Vanek	R Kramer*	R L Robinson
Spaniels (Irish Water)	J A Vanek	R Kramer*	R L Robinson
Spaniels (Sussex)	J A Vanek	R Kramer*	R L Robinson
Spaniels (Welsh Springer)	J A Vanek	R Kramer*	R L Robinson
Spinoni Italiani	J A Vanek	H A Glendinning	R L Robinson
Vizslas	J A Vanek	H A Glendinning	R L Robinson
Weimaraners	J A Vanek	R Kramer*	R L Robinson
Wirehaired Pointing Griffons	J A Vanek	R Kramer*	R L Robinson
Wirehaired Vizslas	J A Vanek	H A Glendinning	R L Robinson
HOUD BREEDS	SCBL1-(FRI)	SCBL2-(SAT)	SCBL3-(SUN)
Afghan Hounds	R L Robinson	M S Jones	R Kramer
American English Coonhounds	R L Robinson	M S Jones	R Kramer
American Foxhounds	R L Robinson	M S Jones	R Kramer
Azawakhs	R L Robinson	M S Jones	R Kramer
Basenjis	R L Robinson	M S Jones	R Kramer
Basset Hounds	R L Robinson	M S Jones	R Kramer
Beagles (13 Inch)	R L Robinson	M S Jones	R Kramer

Beagles (15 Inch)	R L Robinson	M S Jones	R Kramer
Black & Tan Coonhounds	R L Robinson	M S Jones	R Kramer
Bloodhounds	R L Robinson	M S Jones	R Kramer
Bluetick Coonhounds	R L Robinson	M S Jones	R Kramer
Borzoi	R L Robinson	M S Jones	R Kramer
Cirnechi dell'Etna	R L Robinson	M S Jones	R Kramer
Dachshunds (Longhaired)	R L Robinson	M S Jones	R Kramer
Dachshunds (Smooth)	R L Robinson	M S Jones	R Kramer
Dachshunds (Wirehaired)	R L Robinson	M S Jones	R Kramer
English Foxhounds	R L Robinson	M S Jones	R Kramer
Grand Basset Griffon Vendeens	R L Robinson	M S Jones	R Kramer
Greyhounds	R L Robinson	M S Jones	R Kramer
Harriers	R L Robinson	M S Jones	R Kramer
Ibizan Hounds	R L Robinson	M S Jones	R Kramer
Irish Wolfhounds	R L Robinson	M S Jones	R Kramer
Norwegian Elkhounds	R L Robinson	M S Jones	R Kramer
Otterhounds	R L Robinson	H A Glendinning*	R Kramer
Petits Bassets Griffons Vendeens	R L Robinson	M S Jones	R Kramer
Pharaoh Hounds	R L Robinson	M S Jones	R Kramer
Plott Hounds	R L Robinson	M S Jones	R Kramer
Portuguese Podengo Pequenos	R L Robinson	M S Jones	R Kramer
Redbone Coonhounds	R L Robinson	M S Jones	R Kramer
Rhodesian Ridgebacks	R L Robinson	M S Jones	R Kramer
Salukis	R L Robinson	M S Jones	R Kramer
Scottish Deerhounds	R L Robinson	M S Jones	R Kramer
Sloughis	R L Robinson	M S Jones	R Kramer
Treeing Walker Coonhounds	R L Robinson	M S Jones	R Kramer
Whippets	R L Robinson	M S Jones	R Kramer
WORKING BREEDS	SCBL1-(FR)	SCBL2-(SAT)	SCBL3-(SUN)
Akitas	D Vice	R L Robinson	H A Glendinning
Alaskan Malamutes	D Vice	J A Vanek	H A Glendinning
Anatolian Shepherd Dogs	D Vice	J A Vanek	H A Glendinning
Bernese Mountain Dogs	D Vice	J A Vanek	H A Glendinning
Black Russian Terriers	D Vice	J A Vanek	H A Glendinning
Boerboels	D Vice	J A Vanek	H A Glendinning
Boxers	D Vice	R L Robinson	H A Glendinning
Bullmastiffs	D Vice	J A Vanek	H A Glendinning
Cane Corso	D Vice	J A Vanek	H A Glendinning
Chinooks	D Vice	J A Vanek	H A Glendinning
Doberman Pinschers	D Vice	J A Vanek	H A Glendinning
Dogo Argentinos	D Vice	J A Vanek	H A Glendinning
Dogues de Bordeaux	D Vice	J A Vanek	H A Glendinning
German Pinschers	D Vice	J A Vanek	H A Glendinning
Giant Schnauzers	D Vice	J A Vanek	H A Glendinning
Great Danes	D Vice	J A Vanek	H A Glendinning
Great Pyrenees	D Vice	J A Vanek	H A Glendinning
Greater Swiss Mountain Dogs	D Vice	J A Vanek	H A Glendinning
Komondorok	D Vice	J A Vanek	H A Glendinning
Kuvaszok	D Vice	J A Vanek	H A Glendinning
Leonbergers	D Vice	J A Vanek	H A Glendinning
Mastiffs	D Vice	J A Vanek	H A Glendinning
Neapolitan Mastiffs	D Vice	J A Vanek	H A Glendinning
Newfoundlands	D Vice	J A Vanek	H A Glendinning
Portuguese Water Dogs	D Vice	J A Vanek	H A Glendinning
Rottweilers	D Vice	R V Horn	H A Glendinning
Saint Bernards	D Vice	J A Vanek	H A Glendinning
Samoyeds	D Vice	J A Vanek	H A Glendinning
Siberian Huskies	D Vice	J A Vanek	H A Glendinning
Standard Schnauzers	D Vice	J A Vanek	H A Glendinning
Tibetan Mastiffs	D Vice	R L Robinson	H A Glendinning
TERRIER BREEDS	SCBL1-(FR)	SCBL2-(SAT)	SCBL3-(SUN)
Airedale Terriers	R Kramer	D Vice	M S Jones
American Hairless Terriers	R Kramer	D Vice	M S Jones
American Staffordshire Terriers	R Kramer	D Vice	M S Jones
Australian Terriers	R Kramer	D Vice	M S Jones
Bedlington Terriers	R Kramer	D Vice	M S Jones
Border Terriers	R Kramer	D Vice	M S Jones
Bull Terriers (Colored)	R Kramer	D Vice	M S Jones
Bull Terriers (White)	R Kramer	D Vice	M S Jones
Cairn Terriers	R Kramer	D Vice	M S Jones

Cesky Terriers	R Kramer	D Vice	M S Jones
Dandie Dinmont Terriers	R Kramer	D Vice	M S Jones
Fox Terriers (Smooth)	R Kramer	D Vice	M S Jones
Fox Terriers (Wire)	R Kramer	D Vice	M S Jones
Glen of Imaal Terriers	R Kramer	D Vice	M S Jones
Irish Terriers	R Kramer	D Vice	M S Jones
Kerry Blue Terriers	R Kramer	D Vice	M S Jones
Lakeland Terriers	R Kramer	D Vice	M S Jones
Manchester Terriers (Standard)	R Kramer	D Vice	M S Jones
Miniature Bull Terriers	R Kramer	D Vice	M S Jones
Miniature Schnauzers	R Kramer	D Vice	M S Jones
Norfolk Terriers	R Kramer	D Vice	M S Jones
Norwich Terriers	R Kramer	D Vice	M S Jones
Parson Russell Terriers	R Kramer	D Vice	M S Jones
Rat Terriers	R Kramer	D Vice	M S Jones
Russell Terriers	R Kramer	D Vice	M S Jones
Scottish Terriers	R Kramer	D Vice	M S Jones
Sealyham Terriers	R Kramer	D Vice	M S Jones
Skye Terriers	R Kramer	D Vice	M S Jones
Soft Coated Wheaten Terriers	R Kramer	D Vice	M S Jones
Staffordshire Bull Terriers	R Kramer	D Vice	M S Jones
Welsh Terriers	R Kramer	D Vice	M S Jones
West Highland White Terriers	R Kramer	D Vice	M S Jones
TOY BREEDS	SCBL1-(Fri)	SCBL2-(Sat)	SCBL3-(Sun)
Affenpinschers	R Kramer	D Vice	M S Jones
Biewer Terriers	R Kramer	D Vice	M S Jones
Brussels Griffons	R Kramer	D Vice	M S Jones
Cavalier King Charles Spaniels	R Kramer	D Vice	M S Jones
Chihuahuas (Long Coat)	R Kramer	D Vice	M S Jones
Chihuahuas (Smooth Coat)	R Kramer	D Vice	M S Jones
Chinese Cresteds	R Kramer	D Vice	M S Jones
English Toy Spaniels (B & P C)	R Kramer	D Vice	M S Jones
English Toy Spaniels (K C & R)	R Kramer	D Vice	M S Jones
Havanese	R Kramer	D Vice	M S Jones
Italian Greyhounds	R Kramer	D Vice	M S Jones
Japanese Chin	R Kramer	D Vice	M S Jones
Maltese	R Kramer	D Vice	M S Jones
Manchester Terriers (Toy)	R Kramer	D Vice	M S Jones
Miniature Pinschers	R Kramer	D Vice	M S Jones
Papillons	R Kramer	D Vice	M S Jones
Pekingese	R Kramer	D Vice	M S Jones
Pomeranians	R Kramer	D Vice	M S Jones
Poodles (Toy)	R Kramer	D Vice	M S Jones
Pugs	R Kramer	D Vice	M S Jones
Russian Toys	R Kramer	D Vice	M S Jones
Shih Tzu	R Kramer	D Vice	M S Jones
Silky Terriers	R Kramer	D Vice	M S Jones
Toy Fox Terriers	R Kramer	D Vice	M S Jones
Yorkshire Terriers	R Kramer	D Vice	M S Jones
NON-SPORTING BREEDS	SCBL1-(Fri)	SCBL2-(Sat)	SCBL3-(Sun)
American Eskimo Dogs	M S Jones	H A Glendinning*	D Vice
Bichons Frises	M S Jones	H A Glendinning*	D Vice
Boston Terriers	M S Jones	H A Glendinning*	D Vice
Bulldogs	M S Jones	R V Horn	D Vice
Chinese Shar-Pei	M S Jones	H A Glendinning*	D Vice
Chow Chows	M S Jones	R V Horn	D Vice
Coton de Tulear	M S Jones	R V Horn	D Vice
Dalmatians	M S Jones	R V Horn	D Vice
Finnish Spitz	M S Jones	R V Horn	D Vice
French Bulldogs	M S Jones	H A Glendinning*	D Vice
Keeshonden	M S Jones	R V Horn	D Vice
Lhasa Apsos	M S Jones	R V Horn	D Vice
Lowchen	M S Jones	H A Glendinning*	D Vice
Norwegian Lundehunds	M S Jones	R V Horn	D Vice
Poodles (Miniature)	M S Jones	R V Horn	D Vice
Poodles (Standard)	M S Jones	R Kramer	D Vice
Schipperkes	M S Jones	H A Glendinning*	D Vice
Shiba Inu	M S Jones	R V Horn	D Vice
Tibetan Spaniels	M S Jones	H A Glendinning*	D Vice
Tibetan Terriers	M S Jones	H A Glendinning*	D Vice

Xoloitzcuintli	M S Jones	R V Horn	D Vice
HERDING BREEDS	SCBL1-(FRI)	SCBL2-(SAT)	SCBL3-(SUN)
Australian Cattle Dogs	H A Glendinning	R L Robinson	M S Jones
Australian Shepherds	H A Glendinning	R L Robinson	M S Jones
Bearded Collies	H A Glendinning	R L Robinson	J A Vanek
Beaucerons	H A Glendinning	R L Robinson	J A Vanek
Belgian Laekenois	H A Glendinning	R L Robinson	J A Vanek
Belgian Malinois	H A Glendinning	R L Robinson	J A Vanek
Belgian Sheepdogs	H A Glendinning	R L Robinson	J A Vanek
Belgian Tervuren	H A Glendinning	R L Robinson	J A Vanek
Bergamasco Sheepdogs	H A Glendinning	R L Robinson	J A Vanek
Berger Picards	H A Glendinning	R L Robinson	M S Jones
Border Collies	H A Glendinning	R L Robinson	J A Vanek
Bouvier des Flandres	H A Glendinning	R L Robinson	J A Vanek
Briards	H A Glendinning	R L Robinson	J A Vanek
Canaan Dogs	H A Glendinning	R L Robinson	J A Vanek
Cardigan Welsh Corgis	H A Glendinning	R L Robinson	J A Vanek
Collies (Rough)	H A Glendinning	R L Robinson	J A Vanek
Collies (Smooth)	H A Glendinning	R L Robinson	J A Vanek
Entlebucher Mountain Dogs	H A Glendinning	R L Robinson	J A Vanek
Finnish Lapphunds	H A Glendinning	R L Robinson	J A Vanek
German Shepherd Dogs	H A Glendinning	R L Robinson	J A Vanek
Icelandic Sheepdogs	H A Glendinning	R L Robinson	J A Vanek
Lancashire Heelers	H A Glendinning	R L Robinson	M S Jones
Miniature American Shepherds	H A Glendinning	R L Robinson	M S Jones
Mudik	H A Glendinning	R L Robinson	J A Vanek
Norwegian Buhunds	H A Glendinning	R L Robinson	J A Vanek
Old English Sheepdogs	H A Glendinning	R L Robinson	J A Vanek
Pembroke Welsh Corgis	H A Glendinning	R L Robinson	J A Vanek
Polish Lowland Sheepdogs	H A Glendinning	R L Robinson	M S Jones
Pulik	H A Glendinning	R L Robinson	J A Vanek
Pumik	H A Glendinning	R L Robinson	M S Jones
Pyrenean Shepherds	H A Glendinning	R L Robinson	J A Vanek
Shetland Sheepdogs	H A Glendinning	R L Robinson	J A Vanek
Spanish Water Dogs	H A Glendinning	R L Robinson	M S Jones
Swedish Vallhunds	H A Glendinning	R L Robinson	J A Vanek
MISC CLASS	SCBL1-(FRI)	SCBL2-(SAT)	SCBL3-(SUN)
Basset Fauve de Bretagne, Danish-Swedish Farm Dogs, Dutch Shepherds, Japanese Akitainu, Kai Kens, Norrbottenspets, Peruvian Inca Orchids, Portuguese Podengo, Russian Tsvetnaya Bolonka, Small Munsterlander & Teddy Roosevelt Terriers.			
There will be Puppy, Bred-By-Exhibitor and Open Classes for each of the Miscellaneous Breeds in each sex.			
	R L Robinson	M S Jones	R Kramer
OBEDIENCE CLASSES	SCBL1-(FRI)	SCBL2-(SAT)	SCBL3-(SUN)
Novice A Class	E Beasley	E Beasley	E Beasley
Novice B Class	E Beasley	E Beasley	E Beasley
Open A Class	E Beasley	E Beasley	E Beasley
Open B Class	E Beasley	E Beasley	E Beasley
Utility A Class	E Beasley	E Beasley	E Beasley
Utility B Class	E Beasley	E Beasley	E Beasley
Beginner Novice A Class	E Beasley	E Beasley	E Beasley
Beginner Novice B Class	E Beasley	E Beasley	E Beasley
Graduate Novice Class	E Beasley	E Beasley	E Beasley
Graduate Open Class	E Beasley	E Beasley	E Beasley
Versatility Class	E Beasley	E Beasley	E Beasley
RALLY CLASSES	SCBL1-(FRI)	SCBL2-(SAT)	SCBL3-(SUN)
Rally Novice A	R V Horn	R V Horn	R V Horn
Rally Novice B	R V Horn	R V Horn	R V Horn
Rally Intermediate	R V Horn	R V Horn	R V Horn
Rally Advanced A	R V Horn	R V Horn	R V Horn
Rally Advanced B	R V Horn	R V Horn	R V Horn
Rally Excellent A	R V Horn	R V Horn	R V Horn
Rally Excellent B	R V Horn	R V Horn	R V Horn
Rally Master	R V Horn	R V Horn	R V Horn
Rally Choice	R V Horn	R V Horn	R V Horn
JUNIOR SHOWMANSHIP	SCBL1-(FRI)	SCBL2-(SAT)	SCBL3-(SUN)
	R V Horn	H A Glendinning	R L Robinson

ATTENTION EXHIBITORS

The Show Site will be available to exhibitors at 1:00 pm Thursday. Dogs must be removed from the show site immediately following Best in Show judging on Sunday.

Exhibitors will be responsible for the cleanliness of their areas.

No double handling will be permitted at this show. Individuals who attempt to double handle from outside the ring in any manner will be subject to action by the Show Committee.

RV parking only will be allowed in designated RV parking areas. Deadline for advance reservation is March 22, 2024. Large vehicles may require two spaces. 30 Amp 110 volt electricity for each spot with water available. There are only 70 spaces. There is a dump station available on the grounds. Refer to RV Parking Form ([See page 36](#)).

Exhibitors will be responsible for clean-up of their parking and camp site.

VENDOR BOOTHS: Refer to Vendor Form ([See page 35](#)).

No vendors in the Events Center Building.

RESERVED GROOMING: Refer to Reserved Grooming Form ([See page 34](#)).

Free Grooming in Sanford Hall, west of the Events Center Building. No exercise pens in the grooming area. Due to limited grooming space, the Show Committee reserves the right to require exhibitors to stack crates. Sanford Hall has been designated a Historical Building; therefore, extreme caution must be used in care of the building. **NO TAPE ALLOWED TO MARK GROOMING AREA ON THE FLOOR.** Grooming - Additional grooming in open-sided show barn, north of Events Center, electrical outlets available.

No dogs are to be left in any building overnight.

Crates will be allowed ringside during the showing of your breed only & must be removed immediately after. Obedience & Rally exhibitors will be allowed to leave crates set up.

On Sunday, groups may be judged two at a time.

Please furnish your own chairs.

No unentered dogs allowed.

All buildings are Non-Smoking.

Any animal in distress on the show grounds will be removed by the Show Committee at the owner's expense.

Move-ups will be allowed.

RETURNED CHECKS: A \$30.00 fee will be charged for all returned checks made out to SKC.

No free catalogs.

No firearms permitted on the premises.

This Club does not agree to arbitrate claims as set forth on the Official AKC entry form for this event.

The following breeds may be judged on the ground or on a ramp: Lagotti Romagnoli, Nova Scotia Duck Tolling Retrievers, American Water Spaniels, Boykin Spaniels, English Springer Spaniels, Field Spaniels, Welsh Springer Spaniels, Grand Basset Griffon Vendeens, Whippets, German Pinschers, Standard Schnauzers, American Staffordshire Terriers, Irish Terriers, Soft Coated Wheaten Terriers, Staffordshire Bull Terriers, Finnish Spitz, Entlebucher Mountain Dogs, Finnish Lapphunds, Icelandic Sheepdogs, Norwegian Buhunds, Australian Cattle Dogs, Polish Lowland Sheepdogs, Spanish Water Dogs, Basset Fauve de Bretagne (Misc) and Norrbottenspets (Misc).

The following breed may be judged on the ground, a ramp, or on a table: Miniature Bull Terriers.

The following breeds may be judged on a ramp or on a table: Mudik and Pulik

The following breeds must be judged on a ramp through all levels of conformation competition: Clumber Spaniels, Sussex Spaniels, Basset Hounds, Cirneco dell'Etna, Kerry Blue Terriers, Bulldogs, Chinese Shar-Pei, Chow Chows and Keeshonden.

PUBLICATION RIGHTS: By entering this show, all owners, handlers, breeders and kennels agree that all rights to televise, videotape, photograph, advertise, promote and publicize or otherwise exploit this show, or the persons or animals participating in it or the results of the competition before, during or after the event, shall belong solely to The American Kennel Club and their respective assigns, including the use of the names, likenesses or biographical matter of all dogs, owners, handlers, breeders and kennels participating in the show and no such owner, handler, breeder or kennel shall allow any other party to make commercial use of any videotape or photograph of any person or animal participating in this competition.

NEW EXHIBITOR BRIEFING on Saturday. Check Judging Program for time & location.

A Recording Fee of 50 cents for each dog, an AKC Event Service Fee of \$3.00 for the first entry of each dog and an AKC Event Service Fee of \$3.50 for each additional entry of the same dog will be required for each recordable single entry class at any Licensed or Member Club Show or Obedience Trial. An AKC Recording fee of \$3.50 for each entry will be required for each dog in Rally. (American Kennel Club Rally Regulation, Chapter 1, Section 4) These Fees are paid to the American Kennel Club.

CANADIAN/FOREIGN EXHIBITORS MUST SUBMIT ENTRIES WITH CHECKS DRAWN ON U.S. ACCOUNTS OR WITH INTERNATIONAL MONEY ORDERS IN U.S. FUNDS.

Entries received prior to the published opening date and time of entries or received prior to the publishing of this premium list will be returned without processing.

A service/processing fee of \$7.00 will be charged to each duplicate entry.

Dogs need be present only for scheduled judging and will be released if not needed for further judging.

Dogs allowed in rings during judging only.

Dogs must be ready for judging. Neither the club nor its Superintendents will be responsible or obligated to furnish any service for notifying exhibitors or their agents of Breed or Class Judging. Judges need not wait for any dog holding up a class. **Owners or agents alone are responsible for the presence of their dogs in the judging rings.**

The Club reserves the right to substitute a prize of equal or greater value.

All trophies must be claimed the day of the show - None will be mailed.

All checks issued as prizes are the sole responsibility of the recipient. Lost, stolen and/or misplaced checks will not be replaced. Checks are valid for 90 days. The Superintendent is not able to cash checks nor will they be accepted toward entry fees.

RETURNED CHECKS/DECLINED CREDIT/DEBIT CARDS do not constitute a valid entry fee. Fees must be paid in guaranteed funds. Checks will not be accepted. The Superintendent will add a fee for completing the transaction and/or reprocessing the entries. Repeated occurrences from the same exhibitors may result in their being put on a CASH ONLY basis.

Entry Fee will not be refunded in the event that a dog is absent, disqualified, excused by Veterinarian or judge or barred from competition by action of the Show Committee.

Exhibitors should follow their veterinarian's recommendation to assure their dogs are free of internal and external parasites, any communicable diseases and have appropriate vaccinations.

No entry fees will be refunded if the Show cannot open or be completed by reason of riots, civil disturbances, fire, extreme and/or dangerous weather conditions, an Act of God, public emergency, act of a public enemy, strikes or any other cause beyond the control of the Club or the Superintendent.

The show giving Club, the Show Superintendent, their agents, employees, etc, assume no responsibility for any loss, damage or injury sustained by exhibitors, handlers, or to any of their dogs or property and further assume no responsibility for injury to children.

No entry shall be made and no entry shall be accepted which specifies any condition as to its acceptance. Entries will not be accepted without fees, signatures or the "Agreement" on the reverse side of the Official AKC Entry Form.

Changes, additions or corrections to entry forms must be received in writing prior to close of entries. Those received by telephone are not acceptable.

Refunds of \$4.00 & less will not be issued due to the costs of processing.

An administrative fee of \$2.50 will be charged for all cancellations or changes made prior to closing of entries.

EXHIBITORS NOTE: Please notify Superintendent of any change of address.

Each Entry processed through Jack Onofrio Dog Shows Telephone Entry Service or Onofrio Online Entry will have a service fee included in the amount charged to the payment card provided. Each user of either service acknowledges they are authorized to charge fees to the card provided for payment and further acknowledges the transaction is made over the phone or internet. Chargebacks on cards are a violation of the agreement to pay all fees included in this premium list and can result in the club refusing future entries from the exhibitor, refusal of entries from the exhibitor by the superintendent until the debt has been paid and/or being placed on a cash only basis with the superintendent.

FAX/EMAIL ENTRIES AND PAPER ENTRIES WITH CREDIT CARD ARE NOT ACCEPTABLE METHODS FOR ENTRIES AND WILL NOT BE PROCESSED. **Online Entries and Checks by Mail are not affected by this change.** If mailing be sure to have the entry with check enclosed arrive prior to the closing date of the show. Please note all entries received via fax or email and/or paper entries with credit card information will be shredded/deleted immediately upon delivery without processing. With credit card security and identity theft concerns we are implementing this change to protect your information from potential abuse. Entry forms are occasionally viewed by others outside of the staff of the Superintendent. We will always be happy to accept entries with payment by check at any of our shows. Stop by and say hello.

Jack Onofrio Dog Shows Telephone Entry Service phone number (405) 427-0405 or toll free (888) 421-0405: This is for Telephone Entry Service ONLY. For Mastercard/Discover/Visa/American Express cardholders. A \$4.75 charge will be added to each entry for use of this service. Mon, Tues, Thurs & Fri 8:00 am to 4:30 pm; Wed 8:00 am to 12:00 noon.

Onofrio Online Entry at www.onofrio.com for entries made with Mastercard/Discover/Visa/American Express. A **nonrefundable** \$2.95 charge will be added to each entry for use of this service.

Special Delivery & Overnight Delivery Mail Address: 3401 NE 23rd St, Oklahoma City, Oklahoma 73121-2447
FOR SPECIAL & OVERNIGHT DELIVERY MAIL ONLY!



CGC TESTING
by
approved CGC Evaluator
Kathleen Reynolds
kmreynolds6home@gmail.com



Sat, after Obedience & Rally are done in the proofing area between the performance rings

All levels of CGC tested

CGC—\$20

Trick Dog (10 tricks)-\$10

CGC & Trick Dog (5 tricks)-\$30

Bring appropriate collar & leash for your dog per AKC regulation

You can register & pay ahead of time at

PayPal with

scottbluffkennelclub@outlook.com

HOTELS & MOTELS THAT WILL ACCEPT DOGS

Monument Inn & Suites "HOST HOTEL".....(866) 436-1959
"Help support our Host Hotel"
1130 M St, Gering NE 69341 • No Pet Fee



Capri Motel - (308) 635-2057
2424 Ave I, Scottsbluff NE • Pet fee will be refunded after stay
Continental Breakfast

Cobblestone Inn - (307) 532-1033
1306 Main St, Torrington, WY 82440 • \$50.00 Pet Fee per dog

Econo Lodge - (866) 306-0946 (308) 275-4555
2202 Delta Drive, Scottsbluff, NE 69341
No Pet Fee - Continental Breakfast

Hampton Inn - (855) 406-3527
301 West Hwy 26, Scottsbluff, NE • \$50 Pet Fee per Stay

Holiday Inn - (308) 632-1000
1821 Frontage Rd, Scottsbluff NE
\$30.00 Pet Fee per night per dog • Dog Limit Per Room

Quality Inn - (308) 632-7510
1902 21st Street, Scottsbluff, NE
No Pet Fee

Travelodge - (308) 217-4327
707 E Webster, Morrill NE - 6 miles from show site
\$20.00 Pet Fee per Stay • 24 Hour Diner Next Door

RV PARKS THAT WILL ACCEPT DOGS

Caption Critters Country Campground - (308) 765-4260
180454 Hwy 26 Frontage Rd
Pull through sites with Full Hook-ups and a Dog Park • 5 Miles from Show Site
Pet Friendly with Dog Park

Robidoux RV Park - (308) 436-2046
585 Five Rocks Rd, Gering NE 69341 • Spacious Campsites and Pet Friendly

ATTENTION EXHIBITORS: EACH EXHIBITOR WILL BE HELD RESPONSIBLE FOR CLEANING UP AFTER THEIR DOGS ON THE GROUNDS OF THESE MOTELS. DAMAGES TO ROOMS OR GROUNDS WILL BE REPORTED TO THE EVENT COMMITTEE AND TO THE AKC.

ROUTES TO THE SHOW

Take Highway 26 into Mitchell, turn south at the Junction of Hwy 26 & Hwy 29. Cross the railroad tracks & immediately turn west (right).

Take Highway 92/29W to Mitchell junction. Turn north on Hwy 29 & go approximately 6 miles into Mitchell. Turn west just before crossing the railroad tracks.

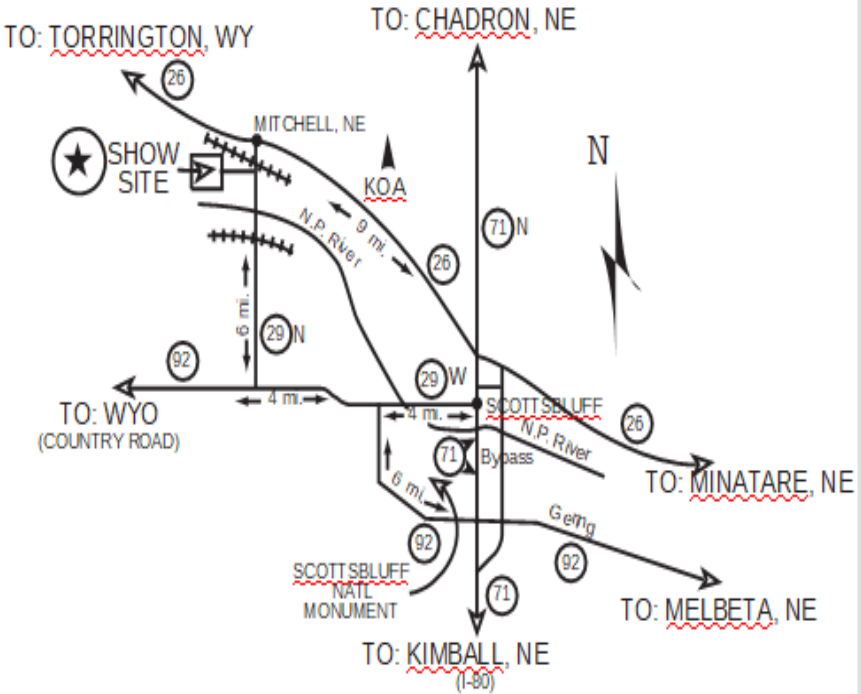

SHOW VETERINARIAN

(ON CALL)

Animal Health Center

Cristin Reese DVM

1906 24 Hwy 26 West • (308) 635-0116

(HOURS)

Mon-Fri 8:00 am to 6:00 pm • Sat 9:00 am to 12:00 pm

Evenings & Saturdays (after 12:00 noon) by Appointment

DIRECTIONS TO VETERINARIAN'S OFFICE: There are no 24 hour animal emergency clinics in our area. The nearest most convenient veterinarian's office is located 1.7 miles west of Hwy 26 & 71 intersection, Scottsbluff NE. Approximately 6 miles from the show site.

SHOW PHOTOGRAPHER

Teddy Lei

8727 Argyle Ave, St Louis MO 63114

(626) 727-2241 • teddyspic77@gmail.com

ATTENTION EXHIBITORS

The Scottsbluff Kennel Club offers a New Title Ribbon to any dog that completes the requirements for its Championship, Grand Championship or earns an Obedience or Rally Title at these shows.
If a trophy becomes unavailable, Scottsbluff Kennel Club reserves the right to substitute an award of similar or greater value.

FRIDAY
BEST IN SHOW & VARIETY GROUP PRIZES

FOR BEST IN SHOW
CUSTOM ROSETTE

Offered by Goshen Veterinary Clinic

FOR RESERVE BEST IN SHOW
CUSTOM ROSETTE

Offered by JG Elliott Insurance Center

FOR BEST OWNER-HANDLED IN SHOW
CUSTOM ROSETTE

Offered by Scottsbluff Kennel Club

FOR RESERVE BEST OWNER-HANDLED IN SHOW
CUSTOM ROSETTE

Offered by Scottsbluff Kennel Club

FOR BEST VETERAN IN SHOW
CUSTOM ROSETTE

Offered by Scottsbluff Kennel Club

In Memory of "Faith" CH M.A.G.I.C's Heart of Fire at Alpine RE

FOR FIRST IN EACH REGULAR VARIETY GROUP
SILVER TRAY

Offered by Scottsbluff Kennel Club, unless otherwise indicated

Working Group - Offered by Noreene Rodgers

FOR FIRST, SECOND, THIRD & FOURTH
IN EACH REGULAR VARIETY GROUP
ROSETTE

Offered by Scottsbluff Kennel Club

FOR FIRST IN EACH OWNER-HANDLED VARIETY GROUP
ROSETTE

Offered by Scottsbluff Kennel Club, unless otherwise indicated

Hound Group - Offered by Mirray Beagles, Miranda Hill

Working Group - Offered by Noreene Rodgers

FOR FIRST, SECOND, THIRD & FOURTH IN
EACH OWNER-HANDLED VARIETY GROUP
ROSETTE

Offered by Scottsbluff Kennel Club

BREED PRIZES

Unless otherwise indicated, the following prizes will be an Embellished Insulated Cup.

SPORTING BREEDS

POINTERS (GERMAN SHORTHAIRED)

BEST OF BREED - Offered by Kathleen Reynolds

POINTERS (GERMAN WIREHAIRD)

BEST OF BREED - Offered by Steve & Suz Ott

HOUND BREEDS

BASENJIS

BEST OF BREED - Offered by JaNell Canaday

BEAGLES (13 INCH)

BEST OF VARIETY - Offered by Mirray Beagles, Miranda Hill

BEAGLES (15 INCH)

BEST OF VARIETY - Offered by Trulisco Beagles, Mary Sullivan

BLUETICK COONHOUNDS

BEST OF BREED - Offered by Painted Sky Performance Dogs, Diana & Brighid Doll

IRISH WOLFHOUSES

BEST OF BREED - Offered by Linda K Veal

WORKING BREEDS

ALASKAN MALAMUTES

BEST OF BREED - Offered by Tyler Nagel

DOBERMAN PINSCHERS

BEST OF BREED - Offered by Head 2 Tail Grooming

ROTTWEILERS

BEST OF BREED - Offered by I'Deal Rottweilers, Susan Deal

SAMOYEDS

BEST OF BREED - Offered by Jeff & Vicki Bott

TERRIER BREEDS

LAKELAND TERRIERS

BEST OF BREED - Offered by Chiropractic Health & Wellness

PARSON RUSSELL TERRIERS

BEST OF BREED - Offered by Snell Service

TOY BREEDS

CHINESE CRESTEDS

BEST OF BREED - Offered by Pin Oaks Cresteds, Amy Morgan

HAVANESE

BEST OF BREED - Offered by Linda Veal

POMERANIANS

BEST OF BREED - Offered by Linda Nagel, in loving memory of "Logan" GCH CH Char's Eclipse of the Night

PUGS

BEST OF BREED - Offered by Shirley & Lori Martischewsky, in loving memory of Summer

TOY FOX TERRIERS

BEST OF BREED - Offered by JaNora Baltz

NON-SPORTING BREEDS

BOSTON TERRIERS

BEST OF BREED - Offered by Carousel Boston Terriers, Judy McCormick

DALMATIANS

BEST OF BREED - Offered by Rene & Jack Keller

FRENCH BULLDOGS

BEST OF BREED - Offered by Paw Spa Boarding & Grooming, Terami Mulinburg

HERDING BREEDS

AUSTRALIAN CATTLE DOGS

BEST OF BREED - Offered by R Diamond Bar Kennels, The Thomas Family

AUSTRALIAN SHEPHERDS

BEST OF BREED - Offered by M Lazy Heart Feed Store, Torrington, WY

BORDER COLLIES

BEST OF BREED - Offered by Painted Sky Performance Dogs, Diana & Brighid Doll

CARDIGAN WELSH CORGIS

BEST OF BREED - Offered by Painted Sky Performance Dogs, Diana & Brighid Doll

COLLIES (SMOOTH)

BEST OF VARIETY - Offered by Shelly Anderson Bogenhagen

GERMAN SHEPHERD DOGS

BEST OF BREED - Offered by Rancho Terra Norte, Val Manning

PEMBROKE WELSH CORGIS

BEST OF BREED - Offered by Briarfox Corgis, Marisa Johnson

SHETLAND SHEEPDOGS

BEST OF BREED - Offered by Legends & Dreams Shetland Sheepdogs, Cheryl Raboin & Cindy Scott

JUNIOR SHOWMANSHIP COMPETITION PRIZES

Unless otherwise indicated, the following prize is offered by Scottsbluff Kennel Club.

BEST JUNIOR HANDLER - Custom Rosette

BEST JUNIOR HANDLER - Embroidered Folding Chair offered by Noreene Rodgers

RESERVE BEST JUNIOR HANDLER - Custom Rosette

RESERVE BEST JUNIOR - Embroidered Folding Chair offered by Ready Set Show

FIRST IN EACH CLASS - Rosette

OBEDIENCE TRIAL PRIZES

Qualifying score required for all prizes in Titling Classes.

A Dark Green Qualifying Ribbon will be given to each dog attaining a Qualifying Score.

PLEASE NOTE: Refund of entry fees for bitches entered in Obedience that come in season after the closing date of this show may be obtained provided that a veterinarian's certificate and a request in writing is received by the Show Superintendent no later than 30 minutes prior to the start of judging.

Transfers will be allowed at this trial per AKC Regulations.

Armbands for this Trial will be arranged in descending Jump Height Order

FOR HIGHEST SCORING DOG IN REGULAR CLASSES

\$75.00

ROSETTE

Offered by Scottsbluff Kennel Club

FOR HIGHEST COMBINED SCORE IN OPEN B & UTILITY CLASSES

\$25.00

ROSETTE

Offered by Scottsbluff Kennel Club

FOR FIRST IN EACH REGULAR OBEDIENCE CLASS

\$15.00

Offered by Scottsbluff Kennel Club

RALLY TRIAL PRIZES

Qualifying score required for all prizes.

A Dark Green Qualifying Ribbon will be given to each dog attaining a Qualifying Score.

PLEASE NOTE: Refund of entry fees for bitches entered in Rally that come in season after the closing date of this show may be obtained provided that a veterinarian's certificate and a request in writing is received by the Show Superintendent no later than 30 minutes prior to the start of judging.

Transfers will be allowed at this trial per AKC Regulations.

Ring Size: 40 ft X 50 ft

FOR HIGHEST SCORING TRIPLE QUALIFYING SCORE

\$75.00

ROSETTE

Offered by Scottsbluff Kennel Club

**FOR HIGHEST COMBINED SCORE IN
ADVANCED B & EXCELLENT B CLASSES**

\$25.00

ROSETTE

Offered by Scottsbluff Kennel Club

FOR FIRST IN EACH REGULAR CLASS

\$15.00

Offered by Scottsbluff Kennel Club

SATURDAY

BEST IN SHOW & VARIETY GROUP PRIZES

FOR BEST IN SHOW

CUSTOM ROSETTE

Offered by the Triskle Border Collies, Joan Beien & Tony Vanbeek

FOR RESERVE BEST IN SHOW

CUSTOM ROSETTE

Offered by the Scottsbluff Kennel Club

FOR BEST OWNER-HANDLED IN SHOW

CUSTOM ROSETTE

Offered by the Scottsbluff Kennel Club

FOR RESERVE BEST OWNER-HANDLED IN SHOW

CUSTOM ROSETTE

Offered by the Scottsbluff Kennel Club

FOR BEST 4-6 MONTH BEGINNER PUPPY IN SHOW

CUSTOM ROSETTE

Offered by the Scottsbluff Kennel Club

FOR FIRST IN EACH REGULAR VARIETY GROUP

SILVER PLATE

Offered by Scottsbluff Kennel Club, unless otherwise indicated

Working Group - Offered by Noreene Rodgers

**FOR FIRST, SECOND, THIRD & FOURTH
IN EACH REGULAR VARIETY GROUP**

ROSETTE

Offered by the Scottsbluff Kennel Club

FOR FIRST IN EACH OWNER-HANDLED VARIETY GROUP

SILVER PLATE

Offered by Scottsbluff Kennel Club, unless otherwise indicated

Hound Group - Offered by Mirray Beagles, Miranda Hill

Working Group - Offered by Noreene Rodgers

Herding Group - Offered by 74 Ranch, Michelle Herbst

**FOR FIRST, SECOND, THIRD & FOURTH IN
EACH OWNER-HANDLED VARIETY GROUP**

ROSETTE

Offered by the Scottsbluff Kennel Club

**FOR FIRST, SECOND, THIRD & FOURTH
IN EACH 4-6 MONTH BEGINNER PUPPY GROUP**

ROSETTE

Offered by Scottsbluff Kennel Club

BREED PRIZES

Unless otherwise indicated, the following prizes will be a Custom Made Tote Bag by Catherine Peterson.

SPORTING BREEDS

POINTERS (GERMAN SHORTHAIRED)

BEST OF BREED - Offered by Kathleen Reynolds

POINTERS (GERMAN WIREHAIRD)

BEST OF BREED - Offered by Steve & Suz Ott

HOUND BREEDS

BASENJIS

BEST OF BREED - Offered by JaNell Canaday

BEAGLES (13 INCH)

BEST OF VARIETY - Offered by Mirray Beagles, Miranda Hill

BEAGLES (15 INCH)

BEST OF VARIETY - Offered by Trulisco Beagles, Mary Sullivan

BLUETICK COONHOUNDS

BEST OF BREED - Offered by Painted Sky Performance Dogs, Diana & Brighid Doll

IRISH WOLFHOUNDS

BEST OF BREED - Offered by Linda K Veal

WORKING BREEDS

ALASKAN MALAMUTES

BEST OF BREED - Offered by Tyler Nagel

DOBERMAN PINSCHERS

BEST OF BREED - Offered by Head 2 Tail Grooming

ROTTWEILERS

BEST OF BREED - Offered by l'Deal Rottweilers, Susan Deal

SAMOYEDS

BEST OF BREED - Offered by Jeff & Vicki Bott

TERRIER BREEDS

LAKELAND TERRIERS

BEST OF BREED - Offered by Chiropractic Health & Wellness

PARSON RUSSELL TERRIERS

BEST OF BREED - Offered by Snell Service

TOY BREEDS

CHINESE CRESTEDS

BEST OF BREED - Offered by Pin Oaks Cresteds, Amy Morgan

HAVANESE

BEST OF BREED - Offered by Linda Veal

POMERANIANS

BEST OF BREED - Offered by Linda Nagel, in loving memory of "Logan" GCH CH Char's Eclipse of the Night

PUGS

BEST OF BREED - Offered by Shirley & Lori Martischewsky, in loving memory of Summer

TOY FOX TERRIERS

BEST OF BREED - Offered by JaNora Baltz

NON-SPORTING BREEDS

BOSTON TERRIERS

BEST OF BREED - Offered by Carousel Boston Terriers, Judy McCormick

DALMATIANS

BEST OF BREED - Offered by Rene & Jack Keller

FRENCH BULLDOGS

BEST OF BREED - Offered by Paw Spa Boarding & Grooming, Terami Mulinburg

HERDING BREEDS

AUSTRALIAN CATTLE DOGS

BEST OF BREED - Offered by R Diamond Bar Kennels, The Thomas Family

AUSTRALIAN SHEPHERDS

BEST OF BREED - Offered by M Lazy Heart Feed Store, Torrington, WY

BORDER COLLIES

BEST OF BREED - Offered by Painted Sky Performance Dogs, Diana & Brighid Doll

CARDIGAN WELSH CORGIS

BEST OF BREED - Offered by Painted Sky Performance Dogs, Diana & Brighid Doll

COLLIES (SMOOTH)

BEST OF VARIETY - Offered by Shelly Anderson Bogenhagen

GERMAN SHEPHERD DOGS

BEST OF BREED - Offered by Rancho Terra Norte, Val Manning

PEMBROKE WELSH CORGIS

BEST OF BREED - Offered by Briarfox Corgis, Marisa Johnson

SHETLAND SHEEPDOGS

BEST OF BREED - Offered by Legends & Dreams Shetland Sheepdogs, Cheryl Raboin & Cindy Scott

JUNIOR SHOWMANSHIP COMPETITION PRIZES

Unless otherwise indicated the following prize is offered by the Scottsbluff Kennel Club

BEST JUNIOR HANDLER - \$750.00 Scholarship (not redeemable for cash)

BEST JUNIOR HANDLER - Custom Rosette

RESERVE BEST JUNIOR HANDLER - \$350.00 Scholarship (not redeemable for cash)

RESERVE BEST JUNIOR HANDLER - Custom Rosette

FIRST IN EACH CLASS - Rosette



The following prizes are offered by the Junior Achievement Challenge.

FIRST IN EACH CLASS - 1 Group of AKC Breed Standards (Junior's Choice)

OBEDIENCE TRIAL PRIZES

Qualifying score required for all prizes in Titling Classes.

A Dark Green Qualifying Ribbon will be given to each dog attaining a Qualifying Score.

PLEASE NOTE: Refund of entry fees for bitches entered in Obedience that come in season after the closing date of this show may be obtained provided that a veterinarian's certificate and a request in writing is received by the Show Superintendent no later than 30 minutes prior to the start of judging.

Transfers will be allowed at this trial per AKC Regulations.

Armbands for this Trial will be arranged in descending Jump Height Order

FOR HIGHEST SCORING DOG IN REGULAR CLASSES

\$75.00

ROSETTE

Offered by the Scottsbluff Kennel Club

FOR HIGHEST COMBINED SCORE IN OPEN B & UTILITY CLASSES

\$25.00

ROSETTE

Offered by the Scottsbluff Kennel Club

FOR FIRST IN EACH REGULAR OBEDIENCE CLASS

\$15.00

Offered by Scottsbluff Kennel Club

JAC OBEDIENCE PRIZES

ALL JUNIOR HANDLERS (9 YRS & UNDER 18 YRS) AWARDED A QUALIFYING SCORE - 1 Group of AKC Breed Standards (Junior's Choice) offered by the Junior Achievement Challenge



RALLY TRIAL PRIZES

Qualifying score required for all prizes.

A Dark Green Qualifying Ribbon will be given to each dog attaining a Qualifying Score.

PLEASE NOTE: Refund of entry fees for bitches entered in Rally that come in season after the closing date of this show may be obtained provided that a veterinarian's certificate and a request in writing is received by the Show Superintendent no later than 30 minutes prior to the start of judging.

Transfers will be allowed at this trial per AKC Regulations.

Ring Size: 40 ft X 50 ft

FOR HIGHEST SCORING TRIPLE QUALIFYING SCORE

\$75.00

ROSETTE

Offered by the Scottsbluff Kennel Club

FOR HIGHEST COMBINED SCORE IN ADVANCED B & EXCELLENT B CLASSES

\$25.00

ROSETTE

Offered by the Scottsbluff Kennel Club

FOR FIRST IN EACH REGULAR CLASS

\$15.00

Offered by Scottsbluff Kennel Club

SUNDAY

BEST IN SHOW & VARIETY GROUP PRIZES

FOR BEST IN SHOW

CUSTOM ROSETTE

Offered by the Scottsbluff Kennel Club

FOR RESERVE BEST IN SHOW

CUSTOM ROSETTE

Offered by the Scottsbluff Kennel Club

FOR BEST OWNER-HANDLED IN SHOW

CUSTOM ROSETTE

Offered by the Scottsbluff Kennel Club

FOR RESERVE BEST OWNER-HANDLED IN SHOW

CUSTOM ROSETTE

Offered by the Scottsbluff Kennel Club

FOR FIRST IN EACH REGULAR VARIETY GROUP

SILVER BOWL

Offered by Scottsbluff Kennel Club, unless otherwise indicated

Working Group - Offered by Noreene Rodgers

**FOR FIRST, SECOND, THIRD & FOURTH
IN EACH REGULAR VARIETY GROUP**

ROSETTE

Offered by the Scottsbluff Kennel Club

FOR FIRST IN EACH OWNER-HANDLED VARIETY GROUP

SILVER BOWL

Offered by Scottsbluff Kennel Club, unless otherwise indicated

Hound Group - Offered by Mirray Beagles, Miranda Hill

Working Group - Offered by Noreene Rodgers

**FOR FIRST, SECOND, THIRD & FOURTH IN
EACH OWNER-HANDLED VARIETY GROUP**

ROSETTE

Offered by the Scottsbluff Kennel Club

BREED PRIZES

Unless otherwise indicated, the following prizes will be an Embellished Spray Bottle.

SPORTING BREEDS

POINTERS (GERMAN SHORTHAIRED)

BEST OF BREED - Offered by Kathleen Reynolds

POINTERS (GERMAN WIREHAIRD)

BEST OF BREED - Offered by Steve & Suz Ott

HOUND BREEDS

BASENJIS

BEST OF BREED - Offered by JaNell Canaday

BEAGLES (13 INCH)

BEST OF VARIETY - Offered by Mirray Beagles, Miranda Hill

BEAGLES (15 INCH)

BEST OF VARIETY - Offered by Trulisco Beagles, Mary Sullivan

BLUETICK COONHOUNDS

BEST OF BREED - Offered by Painted Sky Performance Dogs, Diana & Brighid Doll

IRISH WOLFHOUSES

BEST OF BREED - Offered by Linda K Veal

WORKING BREEDS

ALASKAN MALAMUTES

BEST OF BREED - Offered by Tyler Nagel

DOBERMAN PINSCHERS

BEST OF BREED - Offered by Head 2 Tail Grooming

ROTTWEILERS

BEST OF BREED - Offered by I'Deal Rottweilers, Susan Deal

SAMOYEDS

BEST OF BREED - Offered by Jeff & Vicki Bott

TERRIER BREEDS**LAKELAND TERRIERS**

BEST OF BREED - Offered by Chiropractic Health & Wellness

PARSON RUSSELL TERRIERS

BEST OF BREED - Offered by Snell Service

TOY BREEDS**CHINESE CRESTEDS**

BEST OF BREED - Offered by Pin Oaks Cresteds, Amy Morgan

HAVANESE

BEST OF BREED - Offered by Linda Veal

POMERANIANS

BEST OF BREED - Offered by Linda Nagel, in loving memory of "Logan" GCH CH Char's Eclipse of the Night

PUGS

BEST OF BREED - Offered by Shirley & Lori Martischewsky, in loving memory of Summer

TOY FOX TERRIERS

BEST OF BREED - Offered by JaNora Baltz

NON-SPORTING BREEDS**BOSTON TERRIERS**

BEST OF BREED - Offered by Carousel Boston Terriers, Judy McCormick

DALMATIANS

BEST OF BREED - Offered by Rene & Jack Keller

FRENCH BULLDOGS

BEST OF BREED - Offered by Paw Spa Boarding & Grooming, Terami Mulinburg

HERDING BREEDS**AUSTRALIAN CATTLE DOGS**

BEST OF BREED - Offered by R Diamond Bar Kennels, The Thomas Family

AUSTRALIAN SHEPHERDS

BEST OF BREED - Offered by Offered by M Lazy Heart Feed Store, Torrington, WY

BORDER COLLIES

BEST OF BREED - Offered by Painted Sky Performance Dogs, Diana & Brigid Doll

CARDIGAN WELSH CORGIS

BEST OF BREED - Offered by Painted Sky Performance Dogs, Diana & Brigid Doll

COLLIES (SMOOTH)

BEST OF VARIETY - Offered by Shelly Anderson Bogenhagen

GERMAN SHEPHERD DOGS

BEST OF BREED - Offered by Rancho Terra Norte, Val Manning

PEMBROKE WELSH CORGIS

BEST OF BREED - Offered by Briarfox Corgis, Marisa Johnson

SHETLAND SHEEPDOGS

BEST OF BREED - Offered by Legends & Dreams Shetland Sheepdogs, Cheryl Raboin & Cindy Scott

JUNIOR SHOWMANSHIP COMPETITION PRIZES

Unless otherwise indicated the following prize is offered by the Scottsbluff Kennel Club.

BEST JUNIOR HANDLER - Embroidered Folding Chair by Ready Set Show

BEST JUNIOR HANDLER - Custom Rosette

RESERVE BEST JUNIOR HANDLER - Embroidered Folding Chair offered by Noreene Rodgers

RESERVE BEST JUNIOR HANDLER - Custom Rosette

FIRST IN EACH CLASS - Rosette



The following prizes are offered by the Junior Achievement Challenge.

BEST JUNIOR HANDLER - Large Rosette

FIRST IN EACH CLASS - 1 Group of AKC Breed Standards (Junior's Choice)

OBEDIENCE TRIAL PRIZES

Qualifying score required for all prizes in Titling Classes.

A Dark Green Qualifying Ribbon will be given to each dog attaining a Qualifying Score.

PLEASE NOTE: Refund of entry fees for bitches entered in Obedience that come in season after the closing date of this show may be obtained provided that a veterinarian's certificate and a request in writing is received by the Show Superintendent no later than 30 minutes prior to the start of judging.

Transfers will be allowed at this trial per AKC Regulations.

Armbands for this Trial will be arranged in descending Jump Height Order

FOR HIGHEST SCORING DOG IN REGULAR CLASSES

\$75.00

ROSETTE

Offered by the Scottsbluff Kennel Club

FOR HIGHEST COMBINED SCORE IN OPEN B & UTILITY CLASSES

\$25.00

ROSETTE

Offered by the Scottsbluff Kennel Club

FOR FIRST IN EACH REGULAR OBEDIENCE CLASS

\$15.00

Offered by Scottsbluff Kennel Club



JAC OBEDIENCE PRIZES

ALL JUNIOR HANDLERS (9 YRS & UNDER 18 YRS) AWARDED A QUALIFYING SCORE - 1 Group of AKC Breed Standards (Junior's Choice) offered by the Junior Achievement Challenge

RALLY TRIAL PRIZES

Qualifying score required for all prizes.

A Dark Green Qualifying Ribbon will be given to each dog attaining a Qualifying Score.

PLEASE NOTE: Refund of entry fees for bitches entered in Rally that come in season after closing date of this show may be obtained provided that a veterinarian's certificate and a request in writing is received by the Show Superintendent no later than 30 minutes prior to the start of judging.

Transfers will be allowed at this trial per AKC Regulations.

Ring Size: 40 ft X 50 ft

FOR HIGHEST SCORING TRIPLE QUALIFYING SCORE

\$75.00

ROSETTE

Offered by the Scottsbluff Kennel Club

FOR HIGHEST COMBINED SCORE IN ADVANCED B & EXCELLENT B CLASSES

\$25.00

ROSETTE

Offered by the Scottsbluff Kennel Club

FOR FIRST IN EACH REGULAR CLASS

\$15.00

Offered by Scottsbluff Kennel Club

RESERVED GROOMING SPACE

Reserved grooming spaces are available on a first received, first serve basis. We have reserved grooming spaces in the Morton building just south of the main Event Center. There are only 30 spaces available in this smaller building which is insulated, heated, has excellent lighting and multiple electrical outlets.

There is ample reserved grooming in the Pavillion Building just northeast of the main Event Center which has ample electrical outlets and lighting. The building is well insulated with a hard packed dirt floor. The dog wash stations are just outside this building.

The show committee will mark off all grooming spaces. **Spaces will measure approximately 5' x 10' in the Morton Building and 6'x10' in the Pavillion** for the prepaid cost of \$30.00 for the 3 day show. If you would like to request adjoining spaces, the request must be mailed together in the same envelope. No more than two reservations per envelope. Please indicate which building you prefer. If the Morton building is full, then you will automatically be placed in the new building.

- DO NOT send your reservation request by mail that requires a signature.
- No cancellations & NO refunds.
- A bad check does not constitute a good reservation. There will be a collection fee for any returned check.
- All reserved grooming reservations will be confirmed via email from jbeien@yahoo.com. If you wish to receive them by mail, please send a self addressed stamped envelope for confirmation.
- Grooming spaces may not be moved or exchanged for another space.
- NO exercise pens, cocker pens or puppy pens allowed in the grooming area.
- If the grooming area is full, your request will be returned.
- DEADLINE is Wednesday, March 13, 2024.
- DOGS CAN NOT BE LEFT IN ANY BUILDING OVERNIGHT.

OF SPACES REQUESTED _____

AMOUNT ENCLOSED \$ _____ BUILDING PREFERRED _____

BREED(S) _____

To reserve a space & pay online go to www.scottsbuffkc.org

Make checks payable to: Scottsbuff Kennel Club

Mail to: PO Box 116, Torrington, WY 82440

for questions only please

Name _____

Address _____

City, State, Zip _____

Email _____ Phone _____

I, the undersigned, understand that this reservation will be accepted on a first postmarked, first serve basis & that I will accept the space I am assigned without complaint. I further understand that the reserved grooming space is a privilege that can be forfeited without refund by those who do not follow the regulations of the Mitchell County Fairgrounds & the Scottsbuff Kennel Club, or for causes such as verbal or physical abuse of show officials, event personnel or any animals.

Signature _____ Date _____

VENDOR BOOTH RESERVATION FORM

Deadline: Wednesday, March 20, 2024

- Booth size 10' x 10', tables at no charge.
- Charge: \$100.00 per space for all 3 days **for space outside the main event center on cement under awning.**
- Charge: \$125.00 per space for all 3 days **in the new Reserved Grooming Building** with ample electrical outlets and electricity which will be locked at night.
- Fees must be received by deadline to reserve your space, no refunds, no cancellations.

Make checks payable to Scottsbluff Kennel Club (SKC).

Questions?? Call or email Joan Beien

(307) 715-7238 or jbeien@yahoo.com

Booth set up at noon on Thursday.

**TO RESERVE A SPACE GO ONLINE TO www.scottsbluffkc.org
MAIL APPLICATION WITH COMPLETE INFORMATION & FEE TO:
SCOTTSBLUFF KENNEL CLUB
PO BOX 116
TORRINGTON, WY 62440**

BUSINESS NAME _____

CONTACT PERSON _____

ADDRESS _____

CITY, STATE, ZIP _____

PHONE# _____

EMAIL _____

OUTSIDE UNDER AWNING _____ NEW BUILDING _____

NUMBER OF SPACES _____ NUMBER OF TABLES _____

AMOUNT ENCLOSED \$ _____

STEWARDING

Interested in Stewarding 4 hours or more?

Interested in a free lunch?

Please contact: Noreene Rodgers at noreenerodgers@gmail.com

RV PARKING

RV parking will be allowed in designated RV parking areas ONLY & will be available by 1:00 pm on Thursday. Anyone wishing reserved parking must make an advanced application.

- Parking attendant will assign you a spot, 70 spaces available.
- One application is needed per camping vehicle.
- Fee is **\$30.00** per night, large vehicles may need 2 spaces.
- Deadline for advanced reservation is **Wednesday, March 20, 2024.**
- Contact person: **Floyd Dunn at (307) 253-8018 or timbermist@gmail.com**
- 30 Amp 110 volt electricity for each spot, water is available on fairgrounds, but not at each camping spot
- Exhibitors will be responsible for clean-up of the parking space. Dump stations available.
- The club assumes no responsibility for personal injury or death of any person, theft, injury or death of any animal or damage to or loss of property while at or on the show grounds or in transit to and from the shows.
- All reserved overnight parking requires a non-refundable payment in advance.

To reserve a space & pay online go to www.scottsbluffkc.org

**Please mention in the memo your
name, phone number, arrival date, length of rig & if you have slide outs**

or

**MAIL APPLICATION WITH COMPLETE INFORMATION & FEE TO
FLOYD DUNN - PO Box 50278, Casper, WY 82605**

Name _____

Address _____

City, State, Zip _____

Phone _____

Number of Spaces _____ Number of Nights _____ Amount Remitted \$ _____

License Plate # _____

Email _____

OFFICIAL AMERICAN KENNEL CLUB ENTRY FORM

BOTH SIDES OF ENTRY FORM MUST BE SUBMITTED • Appropriate Box(es) MUST BE CHECKED

ALL BREED DOG SHOWS, OBEDIENCE TRIALS & RALLY TRIALS

SCOTTSBLUFF KENNEL CLUB, INC.

- FRIDAY, MARCH 29, 2024 • SATURDAY, MARCH 30, 2024
- 4-6 BEGINNER PUPPY, SATURDAY SUNDAY, MARCH 31, 2024

SCOTTS BLUFF COUNTY FAIRGROUNDS

Events Center Building • 130625 County Road E • Mitchell, Nebraska 69357

See Page 3 for entry fees

ENTRIES CLOSE WEDNESDAY NOON, MARCH 13, 2024, or when the limit has been reached, if reached prior to this date, at Superintendent's Office. (See limit on Page 1)

MAIL ENTRIES with Fees Payable to JACK ONOFRIO, PO Box 25764, Oklahoma City, Oklahoma 73125-0764.

NOTICE: PLEASE PUT BREED & NAME OF SHOW ON CHECKS. I ENCLOSE \$ _____ for entry fees.
IMPORTANT - Read Carefully instructions on reverse side before filling out. Numbers in the boxes indicate sections of the instructions relevant to the information needed in that box (PLEASE PRINT).

BREED		VARIETY (1)	SEX
DOG (2) (3) SHOW CLASS		CLASS (3) DIVISION Weight, Color, Etc.	
ADDITIONAL CLASSES	OBEDIENCE CLASS (Jump Height)	RALLY CLASS (Jump Height)	JR. SHOWMANSHIP CLASS
NAME OF (See Back) JUNIOR HANDLER (if any)		JR. HANDLER AKC #	
FULL NAME OF DOG		DATE OF BIRTH	
Enter number here		PLACE OF BIRTH (list country) Do not print the above in the catalog	
<input type="checkbox"/> AKC® NO.			
<input type="checkbox"/> PAL NO.			
<input type="checkbox"/> FOREIGN REG. NO. & COUNTRY			

BREEDER _____

SIRE _____

DAM _____

Exhibitor's Code _____

ACTUAL OWNER(S) [4] _____
(Please Print)

OWNER'S ADDRESS _____

CITY _____ **STATE** _____ **ZIP + 4** _____

NAME OF OWNER'S AGENT (IF ANY) AT THIS SHOW _____ **CODE #** _____

I CERTIFY that I am the actual owner of the dog, or that I am the duly authorized agent of the actual owner whose name I have entered above. In consideration of the acceptance of this entry I (we) agree to abide by the rules and regulations of the American Kennel Club in effect at the time of this event, and by any additional rules and regulations appearing in the premium list for this event, and further agree to be bound by the "Agreement" printed on the reverse side of this entry form. I (we) certify and represent that the dog entered is not a hazard to persons or other dogs. This entry is submitted for acceptance on the foregoing representation and Agreement. I (we) agree to conduct myself (ourselves) in accordance with all such Rules and Regulations (including all provisions applying to discipline) and to abide by any decisions made in accord with them.

SIGNATURE of owner or his agent
duly authorized to make this entry _____

Telephone () _____

ARE YOU A NEW EXHIBITOR? Yes No **OWNER-HANDLED ELIGIBLE? Yes No**

Email address: _____

(An acknowledgement or receipt of entry may be sent to this email address)

CHECK THIS BOX TO RECEIVE A PRINTED JUDGING PROGRAM

Emergency Contact: _____ **Telephone ()** _____

AGREEMENT

I (we) agree that the club holding this event has the right to refuse this entry for cause which the club shall deem sufficient. In consideration of the acceptance of this entry and of the holding of this event and of the opportunity to have the dog judged and to win prizes, ribbons, or trophies, I (we) agree to hold the AKC, the event-giving club, their members, directors, governors, officers, agents, superintendents or event secretary and the owner and/or lessor of the premises and any provider of services that are necessary to hold this event and any employees or volunteers of the aforementioned parties, and any AKC approved judge, judging at this event, harmless from any claim for loss or injury which may be alleged to have been caused directly or indirectly to any person or thing by the act of this dog while in or about the event premises or grounds or near any entrance thereto, and I (we) personally assume all responsibility and liability for any such claim; and I (we) further agree to hold the aforementioned parties harmless from any claim for loss, injury or damage to this dog. Additionally, I (we) hereby assume the sole responsibility for and agree to indemnify, defend and save the aforementioned parties harmless from any and all loss and expense (including legal fees) by reason of the liability imposed by law upon any of the aforementioned parties for damage because of bodily injuries, including death at any time resulting therefrom, sustained by any person or persons, including myself (ourselves), or on account of damage to property, arising out of or in consequence of my (our) participation in this event, however such, injuries, death or property damage may be caused, and whether or not the same may have been caused or may be alleged to have been caused by the negligence of the aforementioned parties or any of their employees, agents, or any other persons. **I (WE) AGREE THAT ANY CAUSE OF ACTION, CONTROVERSY OR CLAIM ARISING OUT OF OR RELATED TO THE ENTRY, EXHIBITION OR ATTENDANCE AT THE EVENT BETWEEN THE AKC AND THE EVENT-GIVING CLUB (UNLESS OTHERWISE STATED IN ITS PREMIUM LIST) AND MYSELF (OURSELVES) OR AS TO THE CONSTRUCTION, INTERPRETATION AND EFFECT OF THIS AGREEMENT SHALL BE SETTLED BY ARBITRATION PURSUANT TO THE APPLICABLE RULES OF THE AMERICAN ARBITRATION ASSOCIATION. HOWEVER, PRIOR TO ARBITRATION ALL APPLICABLE AKC BYLAWS, RULES, REGULATIONS AND PROCEDURES MUST FIRST BE FOLLOWED AS SET FORTH IN THE AKC CHARTER AND BYLAWS, RULES, REGULATIONS, PUBLISHED POLICIES AND GUIDELINES.**

INSTRUCTIONS

1. (Variety) if you are entering a dog of breed in which there are varieties for show purposes, please designate the particular variety you are entering i.e., Cocker Spaniel (solid color black, ASCOB, parti-color). Beagles (not exceeding 13 in. over 13 in. but not exceeding 15 in.). Dachshunds (longhaired, smooth, wirehaired), Bull Terriers (colored, white), Manchester Terriers (standard, toy), Chihuahuas (smooth coat, long coat), English Toy Spaniels (King Charles and Ruby, Blenheim and Prince Charles), Poodles (toy, miniature, standard), Collies (rough, smooth),
2. The following categories of dogs may be entered and shown in Best of Breed competition; Dogs that are Champions of Record and dogs which, according to their owner's records, have completed the requirements for a championship, but whose championships are unconfirmed. The showing of unconfirmed Champions in Best of Breed competition is limited to a period of 90 days from the date of the show where the dog completed the requirements for a championship.
3. (Event Class) Consult the classification in this premium list. If the event class in which you are entering your dog is divided, then, in addition to designating the class, specify the particular division of the class in which you are entering your dog, i.e., age division, color division, weight division.
4. A dog must be entered in the name of the person who actually owned it at the time entries for an event closed. If a registered dog has been acquired by a new owner, it must be entered in the name of its new owner in any event for which entries closed after the date of acquirement, regardless of whether the new owner has received the registration certificate indicating that the dog is recorded in his name. State on entry form whether transfer application has been mailed to the AKC (For complete rules refer to Chapter 11, Section 3).
5. Mixed Breed dogs entering classes for Agility, Obedience and Rally trials should mark Breed as AKC Canine Partners Listed Dog "All-American Dog/Mixed Breed." Sire and Dam information shall remain blank for mixed breed entrants.

If this entry is for Jr Showmanship, please enter the following information:

JUNIOR SHOWMANSHIP

JR.'S DATE OF BIRTH _____

AKC JR HANDLER NUMBER _____

The above number **MUST** be included. Should you not have your Junior Handler number, this may be obtained from the AMERICAN KENNEL CLUB. PHONE:(919) 233-9767.

By signing the entry form I (we) certify that the Junior Showman does not now, and will not at any time, act as an agent/handler for pay while continuing to compete in Junior Showmanship.

ADDRESS

City

State

ZIP

OFFICIAL AMERICAN KENNEL CLUB ENTRY FORM

BOTH SIDES OF ENTRY FORM MUST BE SUBMITTED • Appropriate Box(es) MUST BE CHECKED

ALL BREED DOG SHOWS, OBEDIENCE TRIALS & RALLY TRIALS

SCOTTSBLUFF KENNEL CLUB, INC.

- FRIDAY, MARCH 29, 2024 • SATURDAY, MARCH 30, 2024
- 4-6 BEGINNER PUPPY, SATURDAY SUNDAY, MARCH 31, 2024

SCOTTS BLUFF COUNTY FAIRGROUNDS

Events Center Building • 130625 County Road E • Mitchell, Nebraska 69357

See Page 3 for entry fees

ENTRIES CLOSE WEDNESDAY NOON, MARCH 13, 2024, or when the limit has been reached, if reached prior to this date, at Superintendent's Office. (See limit on Page 1)

MAIL ENTRIES with Fees Payable to JACK ONOFRIO, PO Box 25764, Oklahoma City, Oklahoma 73125-0764.

NOTICE: PLEASE PUT BREED & NAME OF SHOW ON CHECKS. I ENCLOSE \$ _____ for entry fees.
IMPORTANT - Read Carefully instructions on reverse side before filling out. Numbers in the boxes indicate sections of the instructions relevant to the information needed in that box (PLEASE PRINT).

BREED		VARIETY (1)	SEX
DOG (2) (3) SHOW CLASS		CLASS (3) DIVISION Weight, Color, Etc.	
ADDITIONAL CLASSES	OBEDIENCE CLASS (Jump Height)	RALLY CLASS (Jump Height)	JR. SHOWMANSHIP CLASS
NAME OF (See Back) JUNIOR HANDLER (if any)		JR. HANDLER AKC #	
FULL NAME OF DOG		DATE OF BIRTH	
Enter number here		PLACE OF BIRTH (list country) Do not print the above in the catalog	
<input type="checkbox"/> AKC® NO.			
<input type="checkbox"/> PAL NO.			
<input type="checkbox"/> FOREIGN REG. NO. & COUNTRY			

BREEDER _____

SIRE _____

DAM _____

Exhibitor's Code _____

ACTUAL OWNER(S) [4] _____
(Please Print)

OWNER'S ADDRESS _____

CITY _____ STATE _____ ZIP + 4 _____

NAME OF OWNER'S AGENT (IF ANY) AT THIS SHOW _____ CODE # _____

I CERTIFY that I am the actual owner of the dog, or that I am the duly authorized agent of the actual owner whose name I have entered above. In consideration of the acceptance of this entry I (we) agree to abide by the rules and regulations of the American Kennel Club in effect at the time of this event, and by any additional rules and regulations appearing in the premium list for this event, and further agree to be bound by the "Agreement" printed on the reverse side of this entry form. I (we) certify and represent that the dog entered is not a hazard to persons or other dogs. This entry is submitted for acceptance on the foregoing representation and Agreement. I (we) agree to conduct myself (ourselves) in accordance with all such Rules and Regulations (including all provisions applying to discipline) and to abide by any decisions made in accord with them.

SIGNATURE of owner or his agent
duly authorized to make this entry _____

Telephone () _____

ARE YOU A NEW EXHIBITOR? Yes No OWNER-HANDLED ELIGIBLE? Yes No

Email address: _____

(An acknowledgement or receipt of entry may be sent to this email address)

CHECK THIS BOX TO RECEIVE A PRINTED JUDGING PROGRAM

Emergency Contact: _____ Telephone () _____

AGREEMENT

I (we) agree that the club holding this event has the right to refuse this entry for cause which the club shall deem sufficient. In consideration of the acceptance of this entry and of the holding of this event and of the opportunity to have the dog judged and to win prizes, ribbons, or trophies, I (we) agree to hold the AKC, the event-giving club, their members, directors, governors, officers, agents, superintendents or event secretary and the owner and/or lessor of the premises and any provider of services that are necessary to hold this event and any employees or volunteers of the aforementioned parties, and any AKC approved judge, judging at this event, harmless from any claim for loss or injury which may be alleged to have been caused directly or indirectly to any person or thing by the act of this dog while in or about the event premises or grounds or near any entrance thereto, and I (we) personally assume all responsibility and liability for any such claim; and I (we) further agree to hold the aforementioned parties harmless from any claim for loss, injury or damage to this dog. Additionally, I (we) hereby assume the sole responsibility for and agree to indemnify, defend and save the aforementioned parties harmless from any and all loss and expense (including legal fees) by reason of the liability imposed by law upon any of the aforementioned parties for damage because of bodily injuries, including death at any time resulting therefrom, sustained by any person or persons, including myself (ourselves), or on account of damage to property, arising out of or in consequence of my (our) participation in this event, however such, injuries, death or property damage may be caused, and whether or not the same may have been caused or may be alleged to have been caused by the negligence of the aforementioned parties or any of their employees, agents, or any other persons. **I (WE) AGREE THAT ANY CAUSE OF ACTION, CONTROVERSY OR CLAIM ARISING OUT OF OR RELATED TO THE ENTRY, EXHIBITION OR ATTENDANCE AT THE EVENT BETWEEN THE AKC AND THE EVENT-GIVING CLUB (UNLESS OTHERWISE STATED IN ITS PREMIUM LIST) AND MYSELF (OURSELVES) OR AS TO THE CONSTRUCTION, INTERPRETATION AND EFFECT OF THIS AGREEMENT SHALL BE SETTLED BY ARBITRATION PURSUANT TO THE APPLICABLE RULES OF THE AMERICAN ARBITRATION ASSOCIATION. HOWEVER, PRIOR TO ARBITRATION ALL APPLICABLE AKC BYLAWS, RULES, REGULATIONS AND PROCEDURES MUST FIRST BE FOLLOWED AS SET FORTH IN THE AKC CHARTER AND BYLAWS, RULES, REGULATIONS, PUBLISHED POLICIES AND GUIDELINES.**

INSTRUCTIONS

1. (Variety) if you are entering a dog of breed in which there are varieties for show purposes, please designate the particular variety you are entering i.e., Cocker Spaniel (solid color black, ASCOB, parti-color). Beagles (not exceeding 13 in. over 13 in. but not exceeding 15 in.). Dachshunds (longhaired, smooth, wirehaired), Bull Terriers (colored, white), Manchester Terriers (standard, toy), Chihuahuas (smooth coat, long coat), English Toy Spaniels (King Charles and Ruby, Blenheim and Prince Charles), Poodles (toy, miniature, standard), Collies (rough, smooth),
2. The following categories of dogs may be entered and shown in Best of Breed competition; Dogs that are Champions of Record and dogs which, according to their owner's records, have completed the requirements for a championship, but whose championships are unconfirmed. The showing of unconfirmed Champions in Best of Breed competition is limited to a period of 90 days from the date of the show where the dog completed the requirements for a championship.
3. (Event Class) Consult the classification in this premium list. If the event class in which you are entering your dog is divided, then, in addition to designating the class, specify the particular division of the class in which you are entering your dog, i.e., age division, color division, weight division.
4. A dog must be entered in the name of the person who actually owned it at the time entries for an event closed. If a registered dog has been acquired by a new owner, it must be entered in the name of its new owner in any event for which entries closed after the date of acquirement, regardless of whether the new owner has received the registration certificate indicating that the dog is recorded in his name. State on entry form whether transfer application has been mailed to the AKC (For complete rules refer to Chapter 11, Section 3).
5. Mixed Breed dogs entering classes for Agility, Obedience and Rally trials should mark Breed as AKC Canine Partners Listed Dog "All-American Dog/Mixed Breed." Sire and Dam information shall remain blank for mixed breed entrants.

If this entry is for Jr Showmanship, please enter the following information:

JUNIOR SHOWMANSHIP

JR.'S DATE OF BIRTH _____

AKC JR HANDLER NUMBER _____

The above number **MUST** be included. Should you not have your Junior Handler number, this may be obtained from the AMERICAN KENNEL CLUB. PHONE:(919) 233-9767.

By signing the entry form I (we) certify that the Junior Showman does not now, and will not at any time, act as an agent/handler for pay while continuing to compete in Junior Showmanship.

ADDRESS

City _____

State _____

ZIP _____